

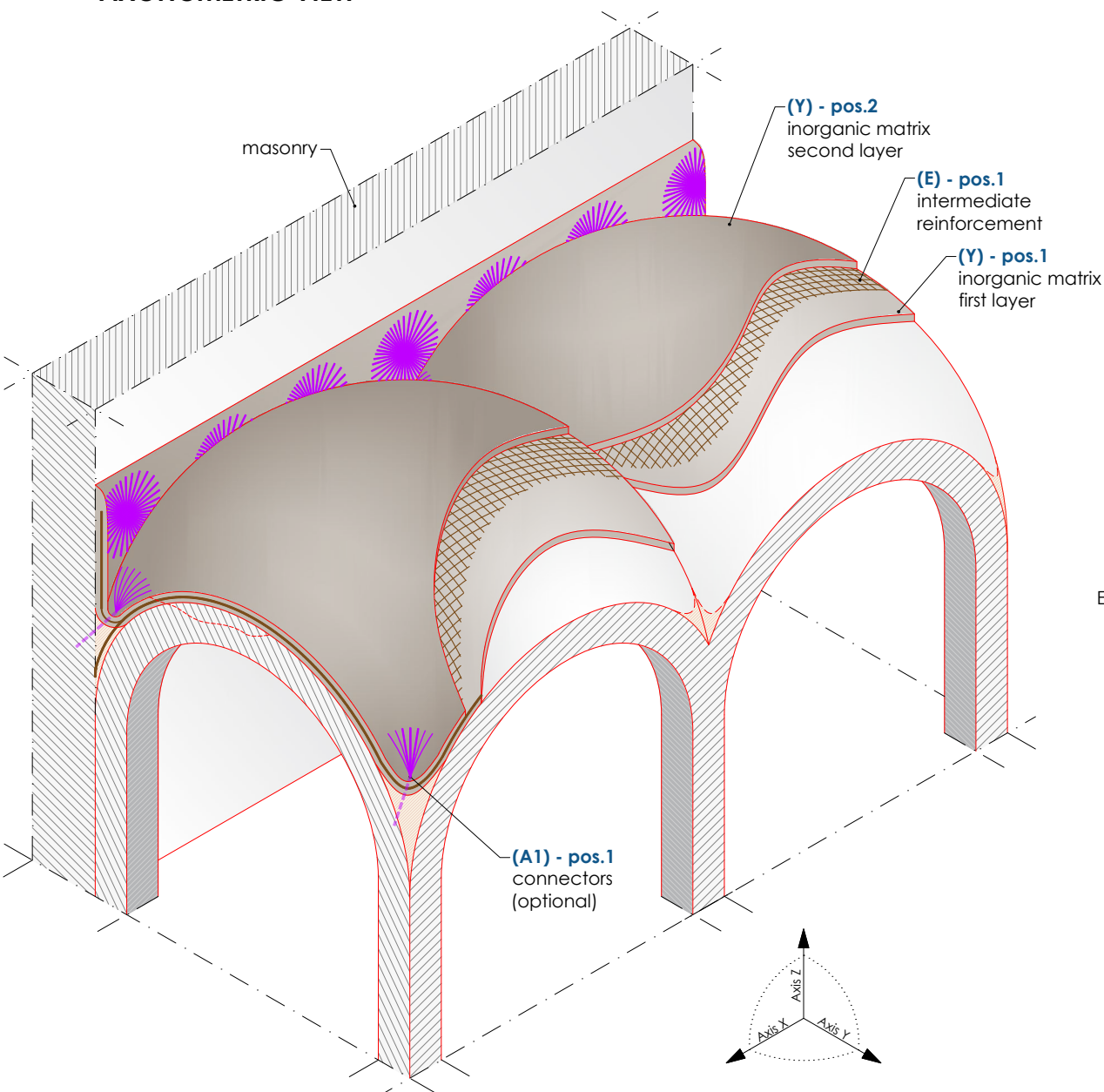

AXONOMETRIC VIEW

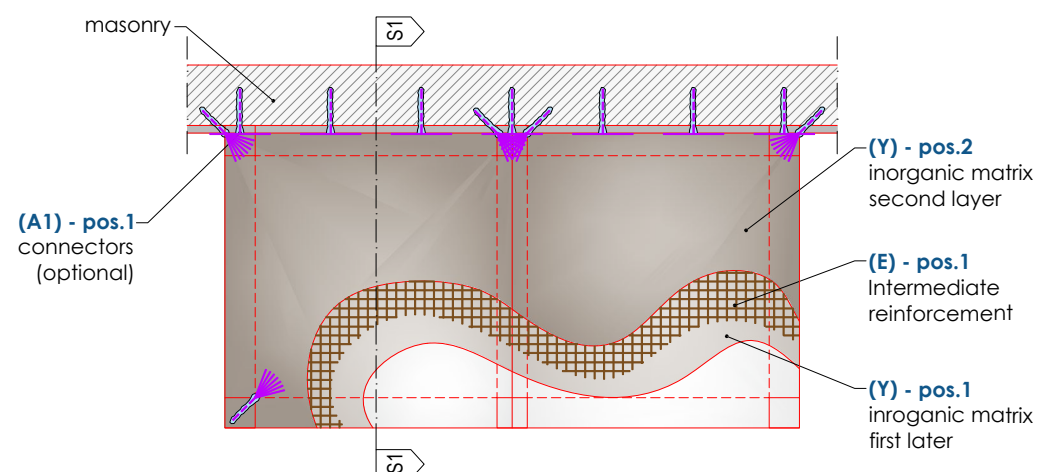

View V1-V1 (scale 1:50)



Detail SOLUTION "A" - Connectors debowed above the second layer of inorganic matrix

The layout, anchoring, and debowing of the connectors must be carried out only after the second layer of inorganic matrix has been applied, once the mortar has fully hardened.

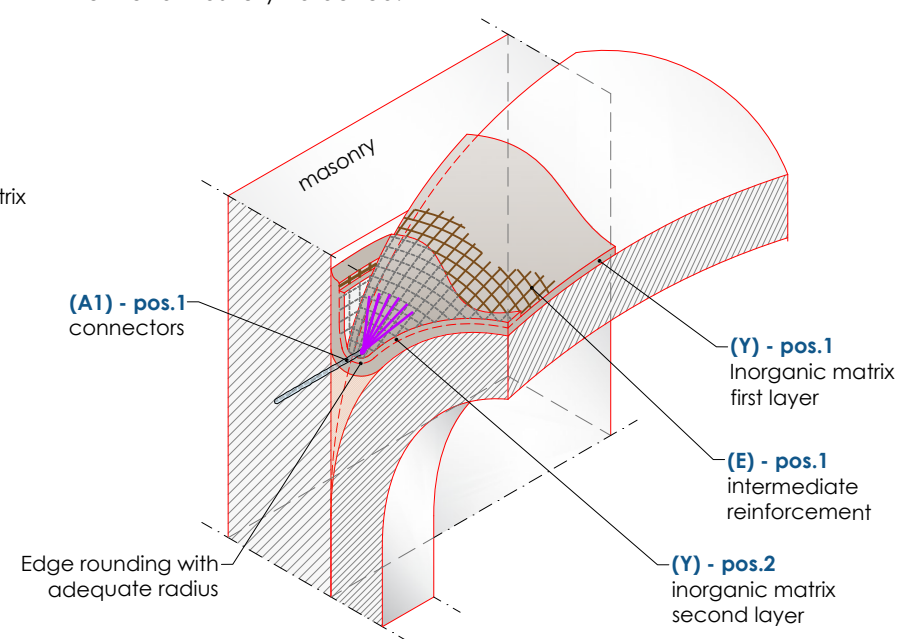

Detail SOLUTION "B" - Connectors debowed above the reinforcement

The layout and anchoring of the connectors must be carried out after Phase 0 – substrate preparation, while the debowing is performed only after the reinforcement has been installed.

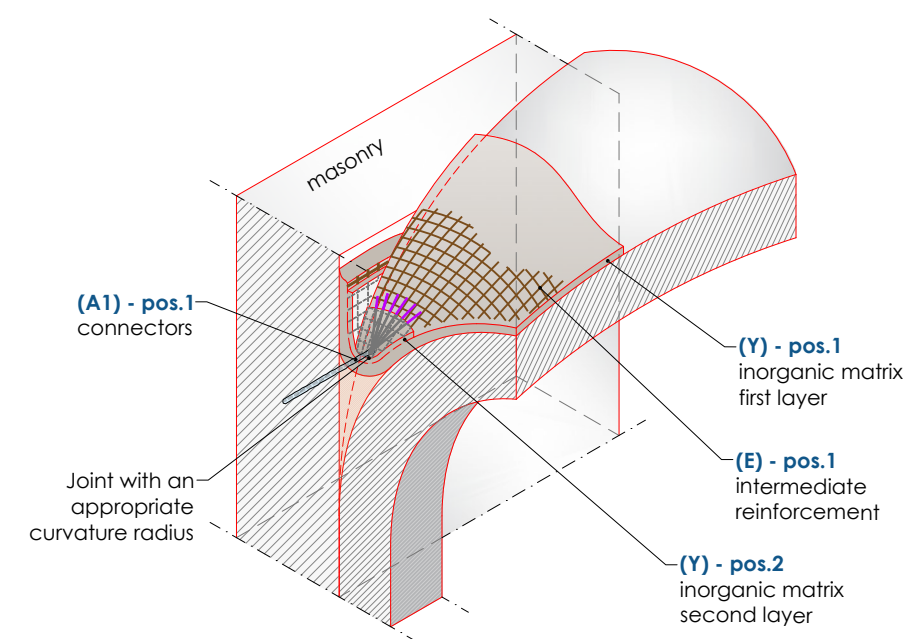

Stratigraphy Detail

application of the second mortar layer

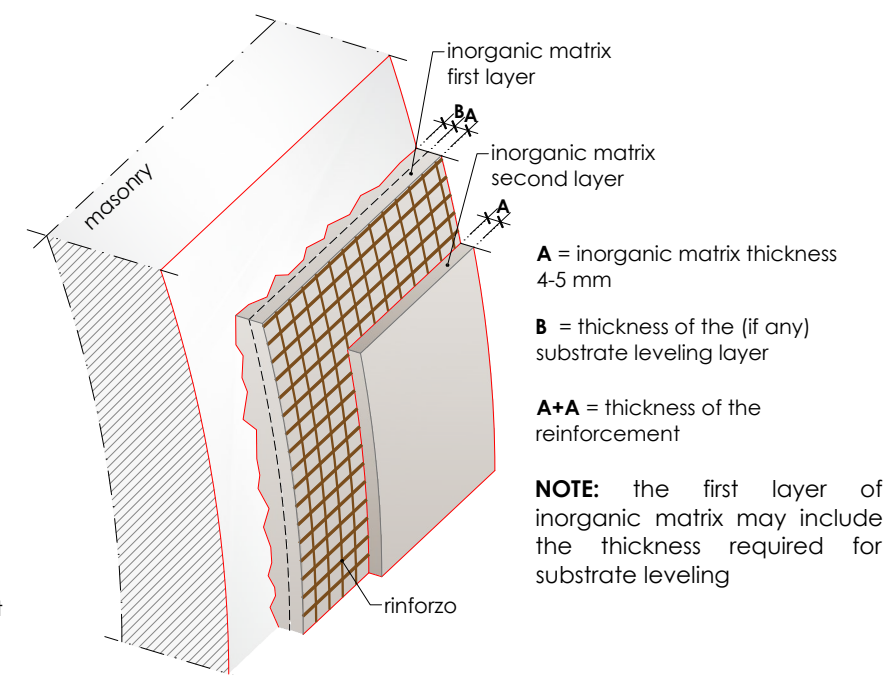

Section S1-S1 (scale 1:25)

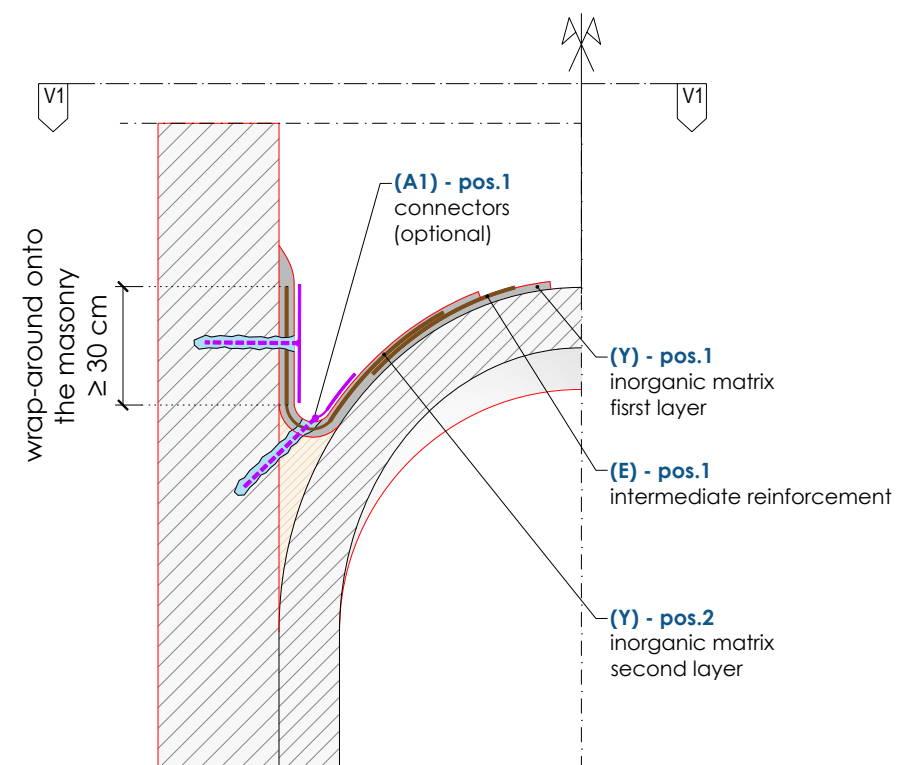

MATERIAL IDENTIFICATION - C-MATRIX system

(Y) INORGANIC MATRIX

(E) REINFORCEMENT

(A1) FB-TUP10-....(bowed bars)

(P3) FB-....INTEGRA FIXA-.... (Anchoring resin)

Dimensions are in mm unless otherwise specified
For the materials table, refer drawing FRCM 08