

AXONOMETRIC VIEW

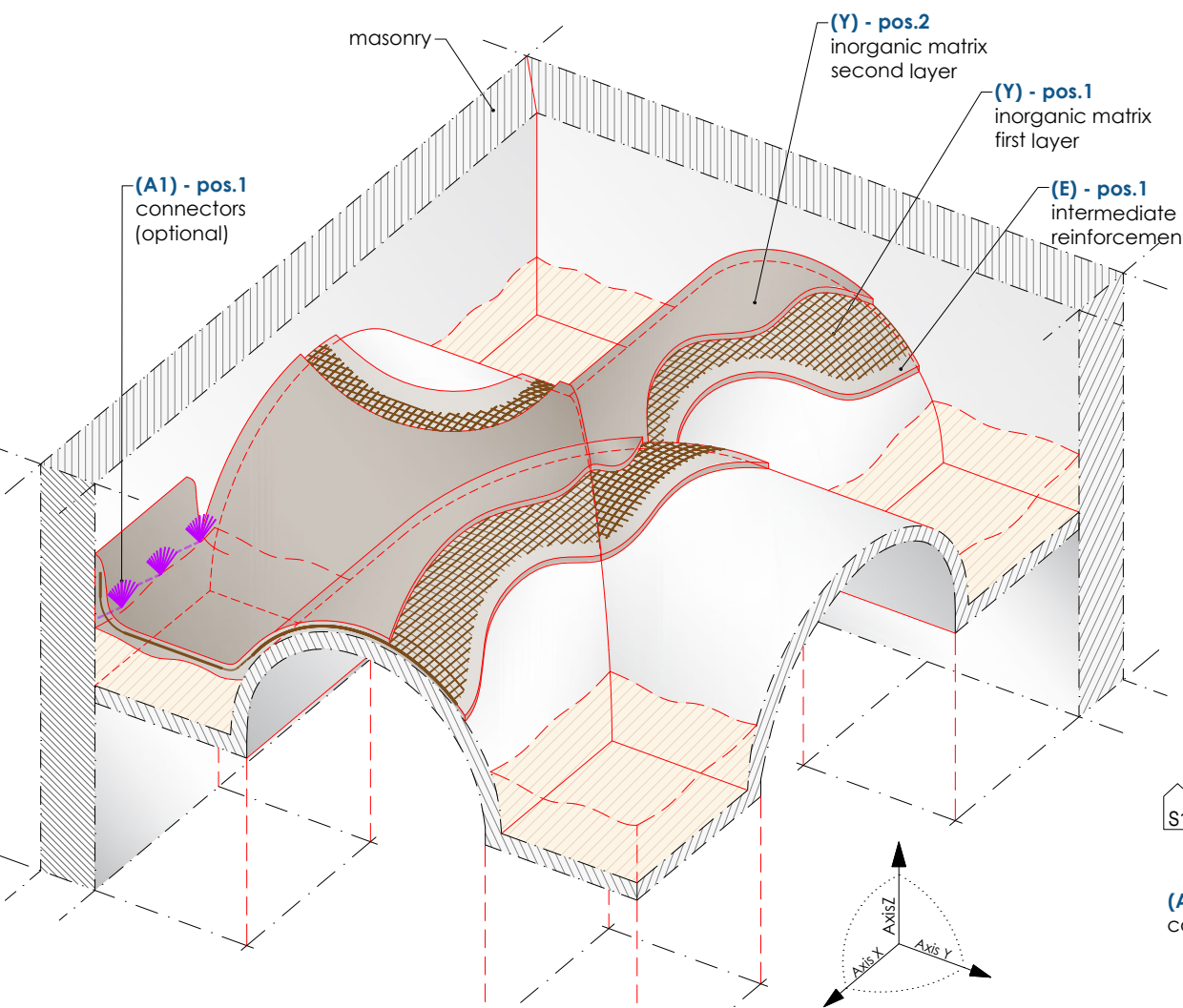

View V1-V1 (scale 1:50)

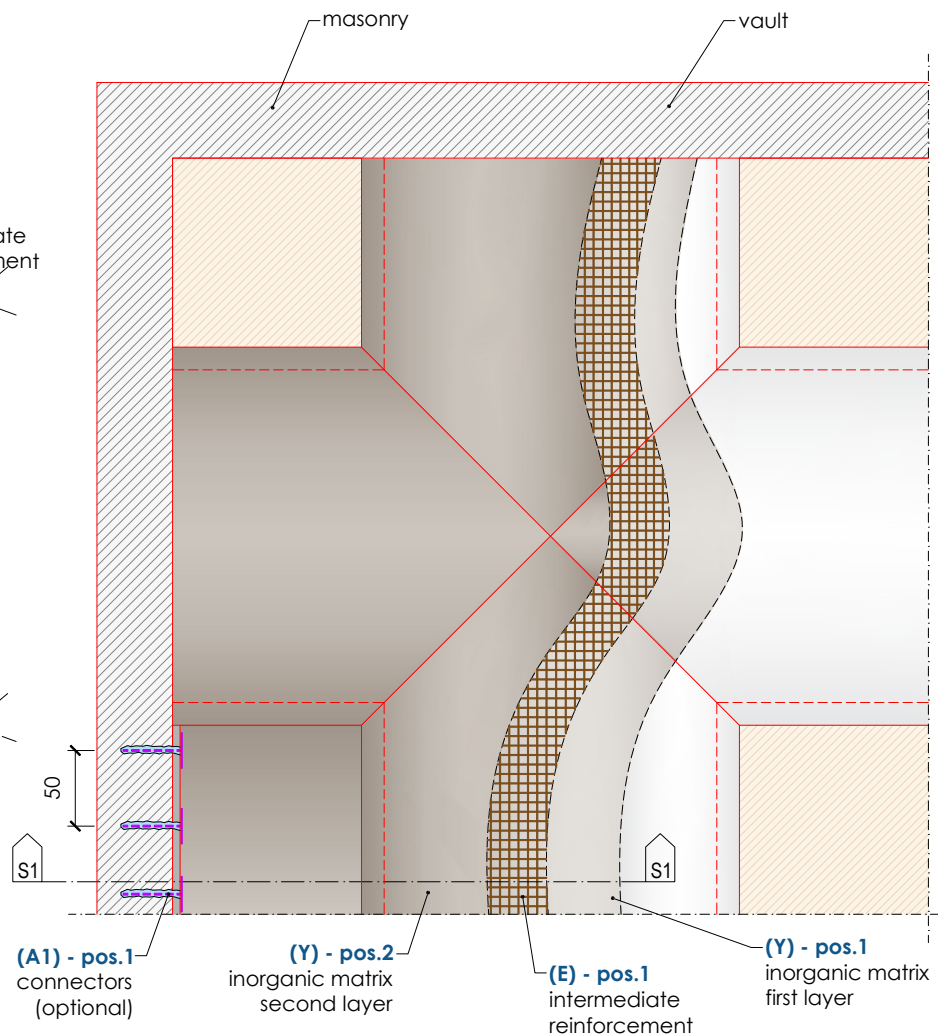

Detail SOLUTION "A" - Debowed connectors over the second layer of inorganic matrix

The layout marking, anchoring, and debowing of the connectors shall be carried out only after the installation of the second layer of inorganic matrix, once the mortar has fully hardened.

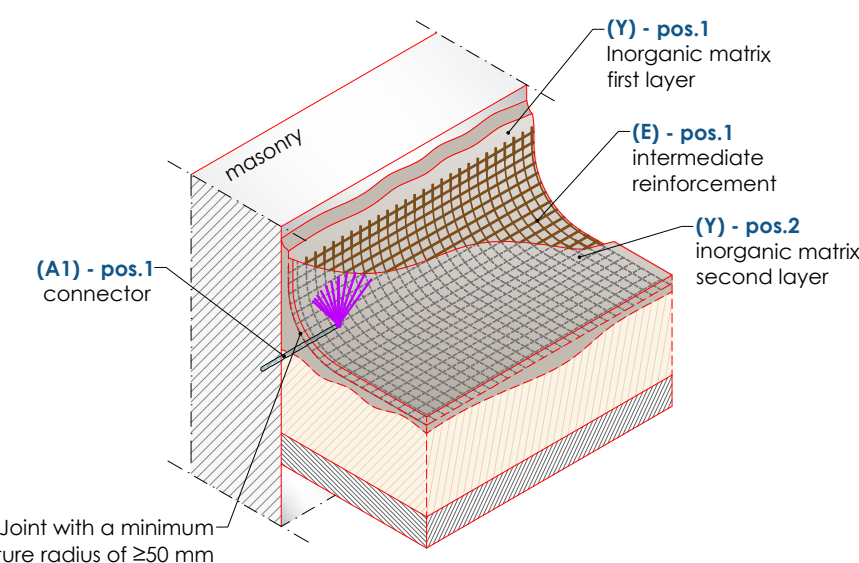

Detail SOLUTION "B" - Debowed connectors over the reinforcement

The layout marking and anchoring of the connectors shall be carried out after Phase 0 of substrate preparation, while the debowing shall be performed only after the reinforcement has been installed..

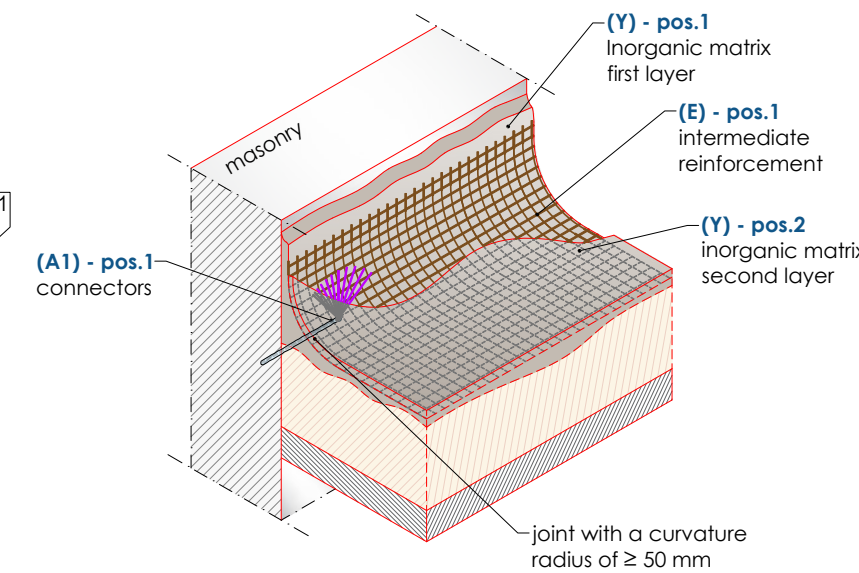

Stratigraphy detail
application of the second mortar layer

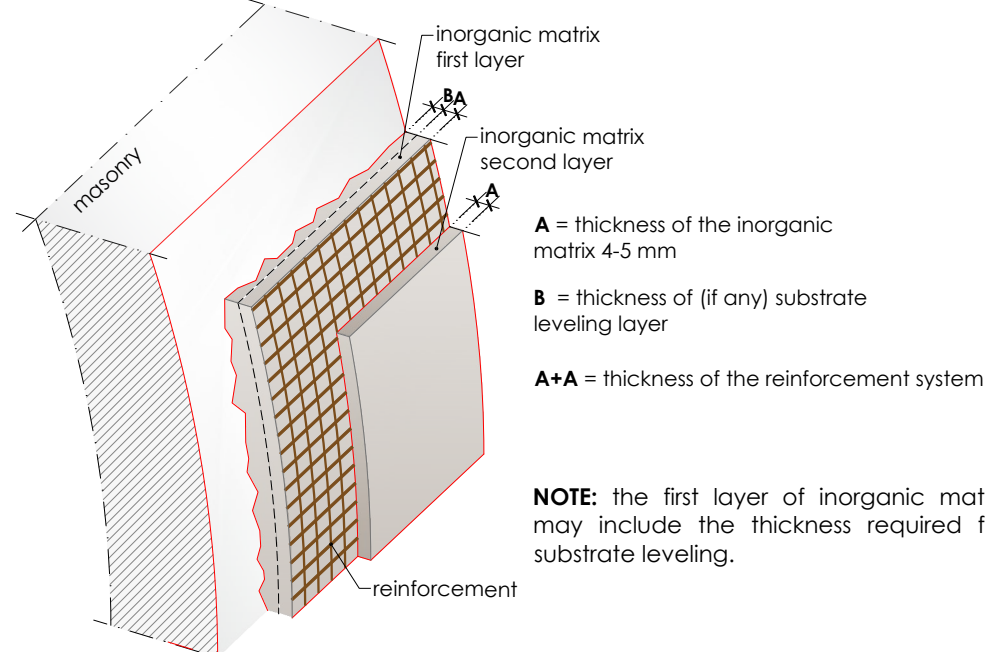

A = thickness of the inorganic matrix 4-5 mm
B = thickness of (if any) substrate leveling layer
A+A = thickness of the reinforcement system

NOTE: the first layer of inorganic matrix may include the thickness required for substrate leveling.

Section S1-S1 (scale 1:50)

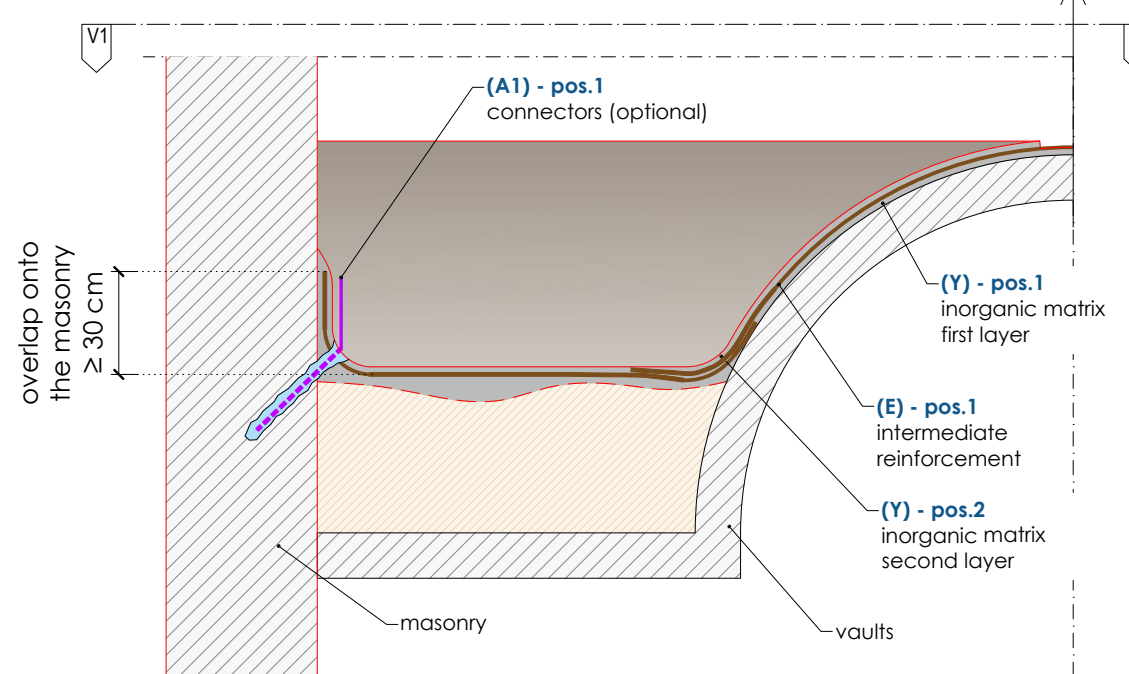

MATERIAL IDENTIFICATION - C-MATRIX system

- (Y) INORGANIC MATRIX
(E) REINFORCEMENT
(A1) FB-TUP10-....(bowed connectors)
(P3) FB-....INTEGRA FIXA-.... (Anchoring Resins)

Dimensions are in mm unless otherwise specified
For the material table, refer to the drawing FRCM08