

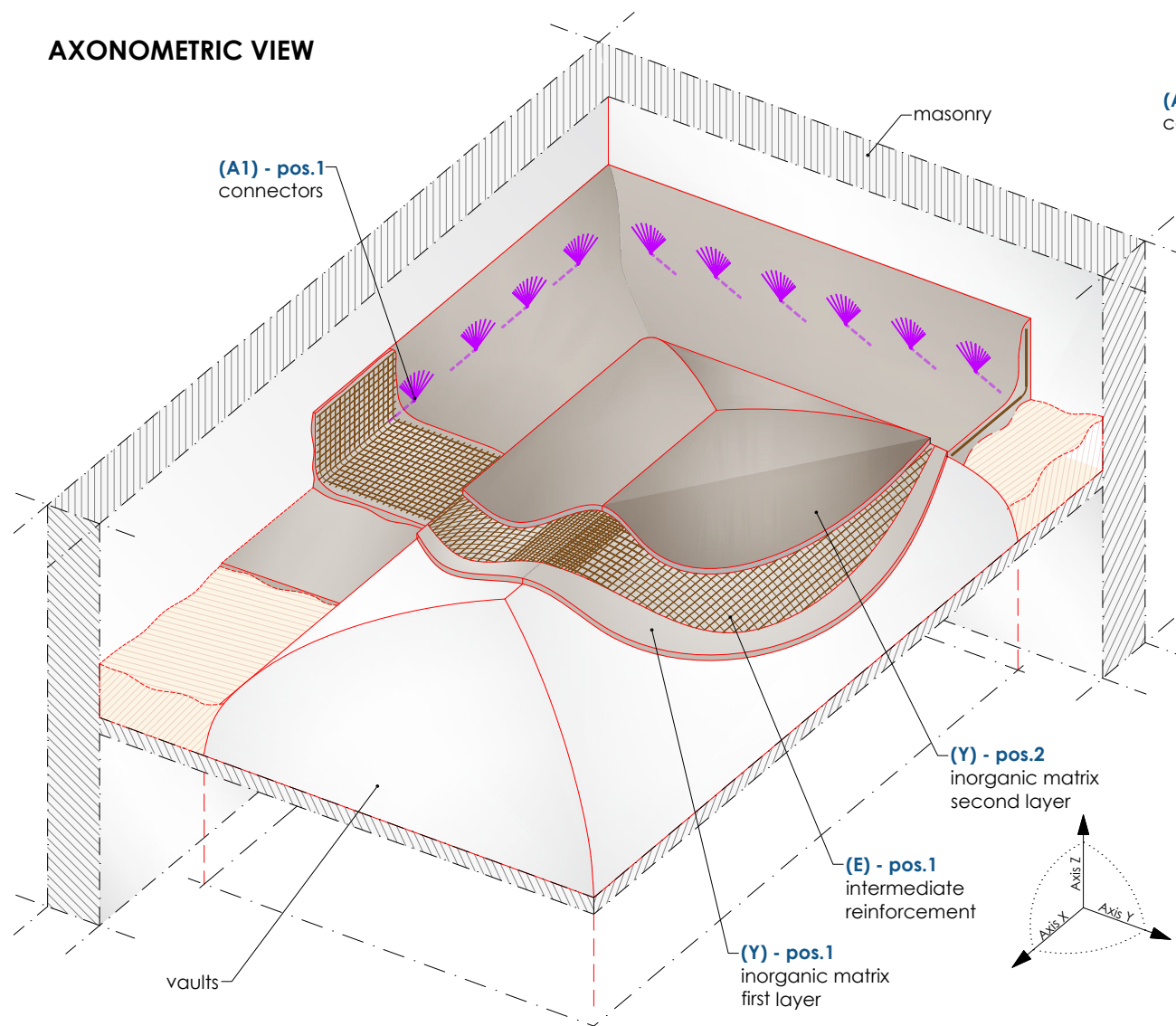

AXONOMETRIC VIEW

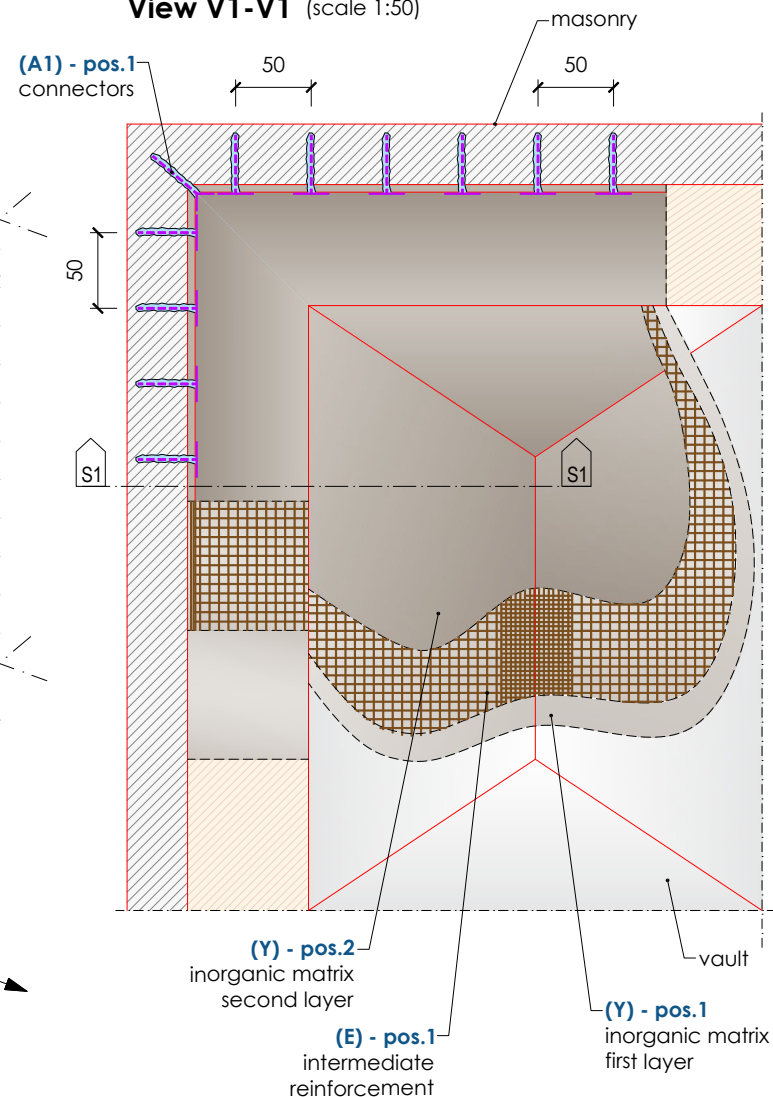

View V1-V1 (scale 1:50)



Detail SOLUTION "A" - Debowed connectors above the second layer of inorganic matrix

The layout, bonding, and de of the debowed connectors must be carried out only after the application of the second layer of inorganic matrix, once the mortar has fully hardened.

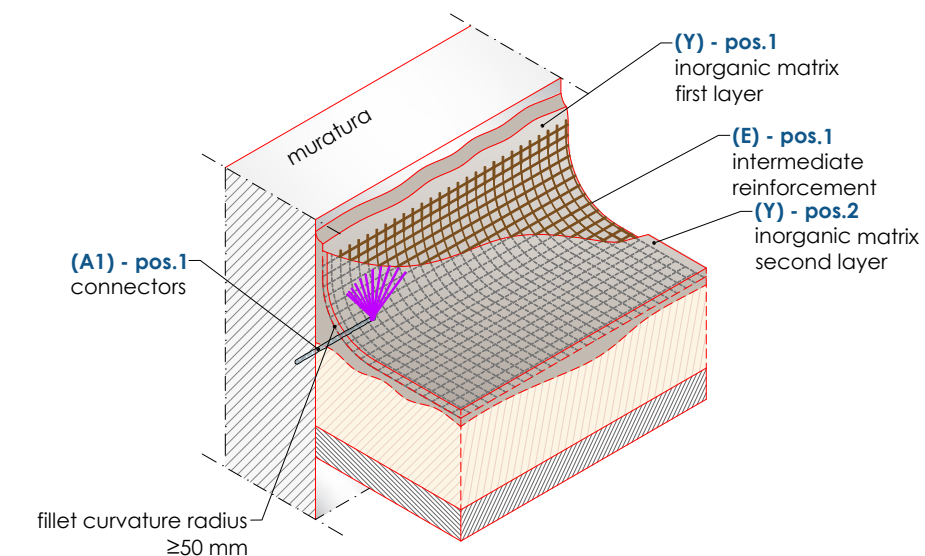

Detail SOLUTION "B" - Debowed connectors above the reinforcement

The layout and anchoring of the connectors must be carried out after PHASE 0 (substrate preparation), while the debowing is performed only after the reinforcement has been installed.

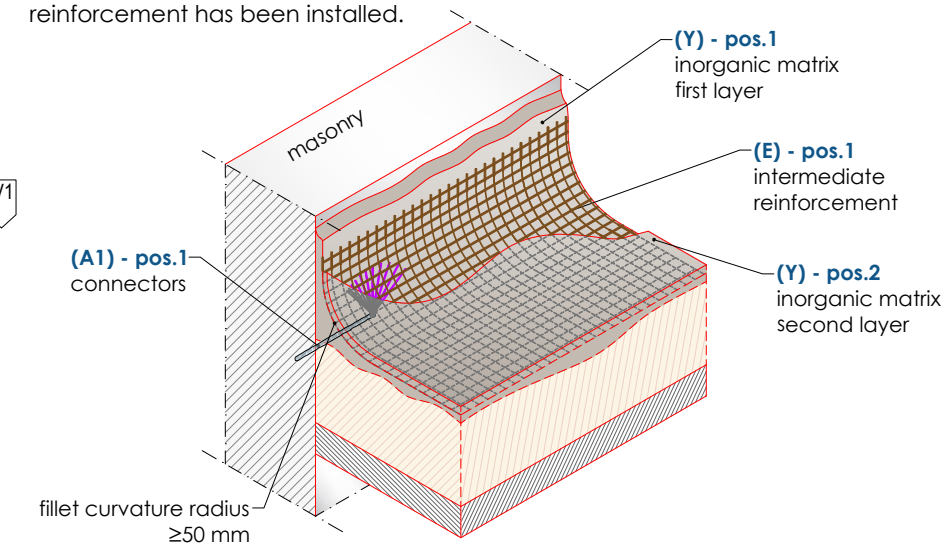

STRATIGRAPHIC DETAIL

Application of the second mortar layer

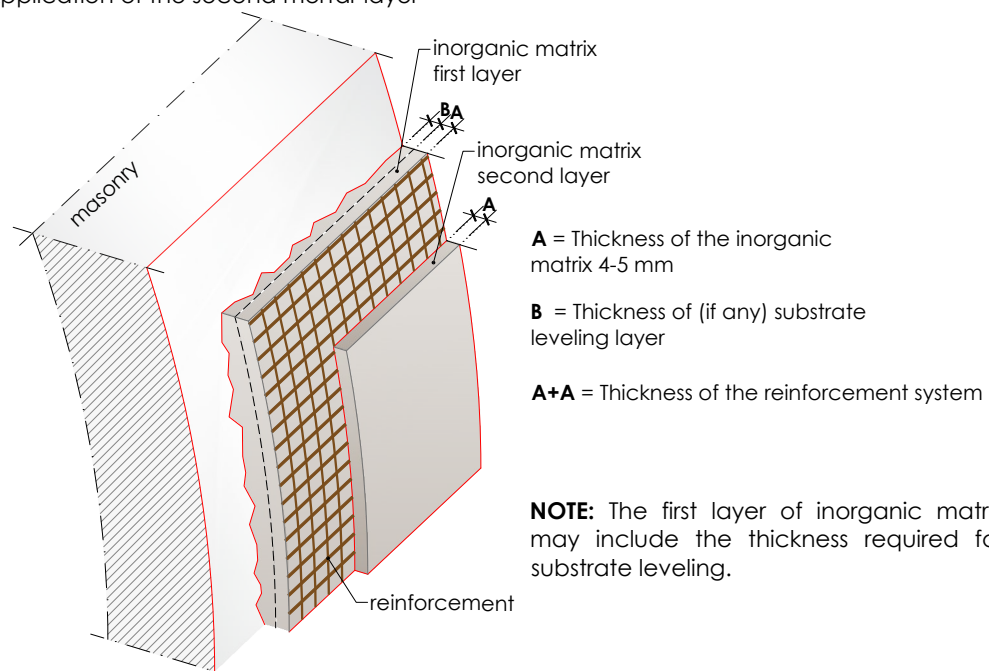

Section S1-S1 (scale 1:25)

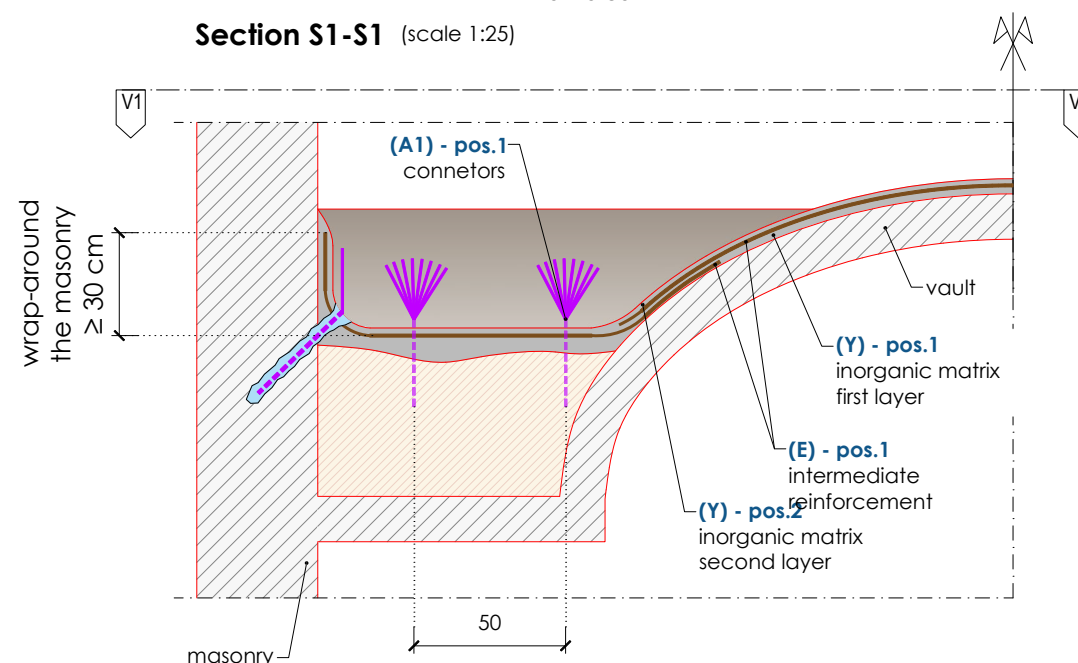

MATERIAL IDENTIFICATION - C-MATRIX system

(Y) INORGANIC MATRIX

(E) REINFORCEMENT

(A1) FB-TUP10-....(bowed connectors)

(P3) FB-....INTEGRA FIXA-.... (anchoring resin)

Dimensions are expressed in mm unless otherwise specified
For the materials table, refer to table FRCM 08

