

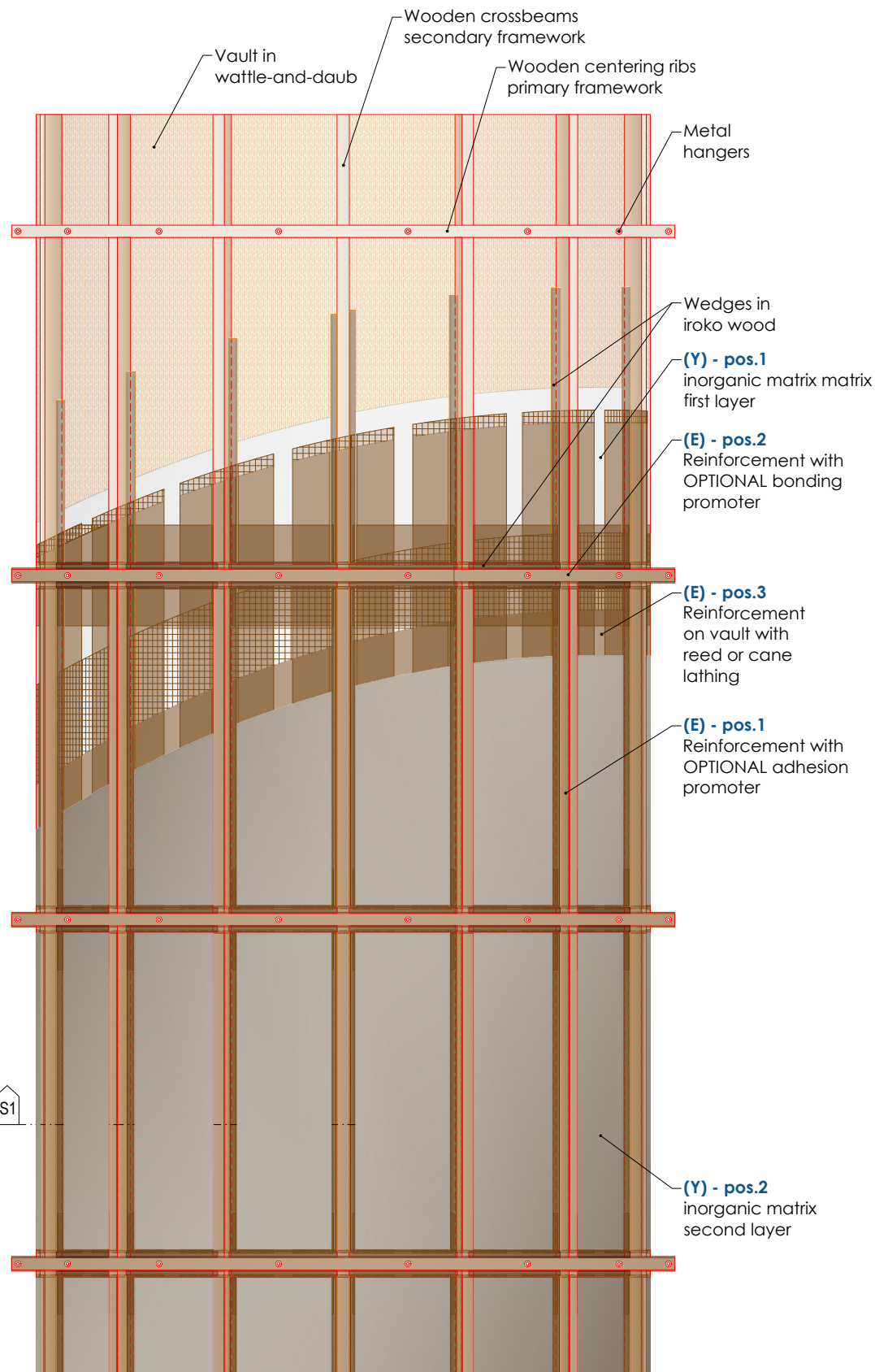

View V1-V1 (scale 1:50)

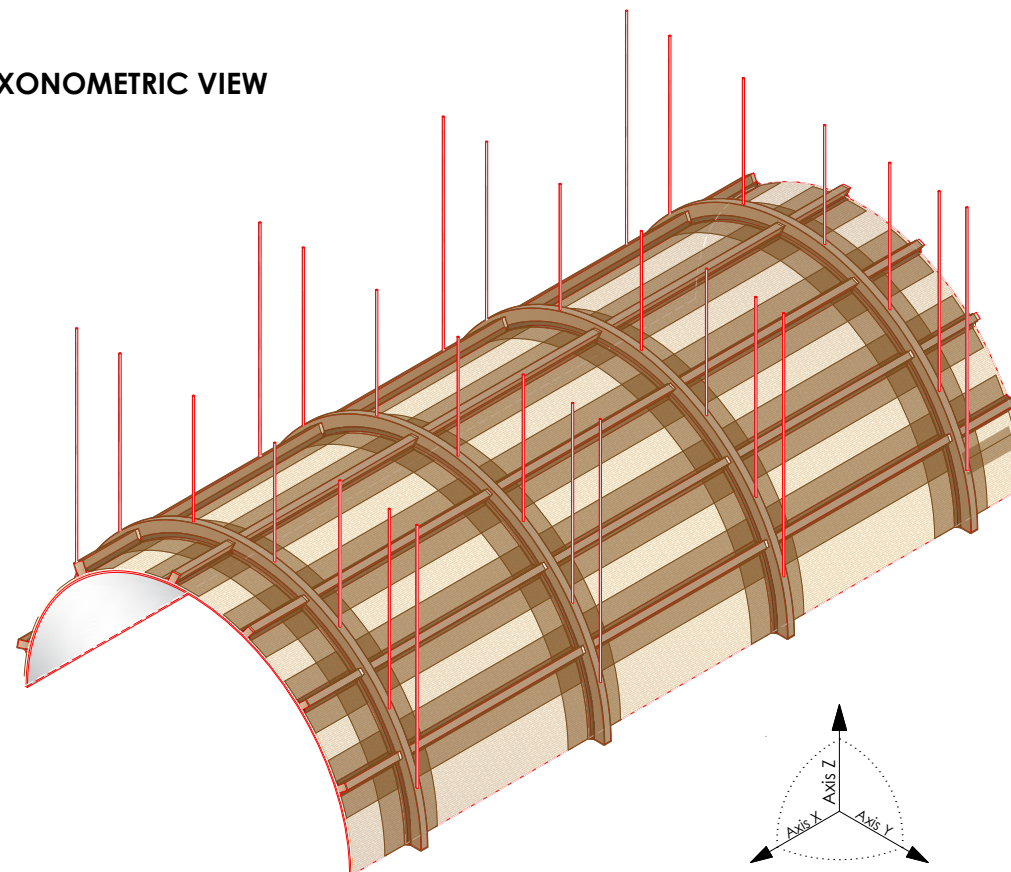

AXONOMETRIC VIEW



Section S1-S1 (scale 1:50)

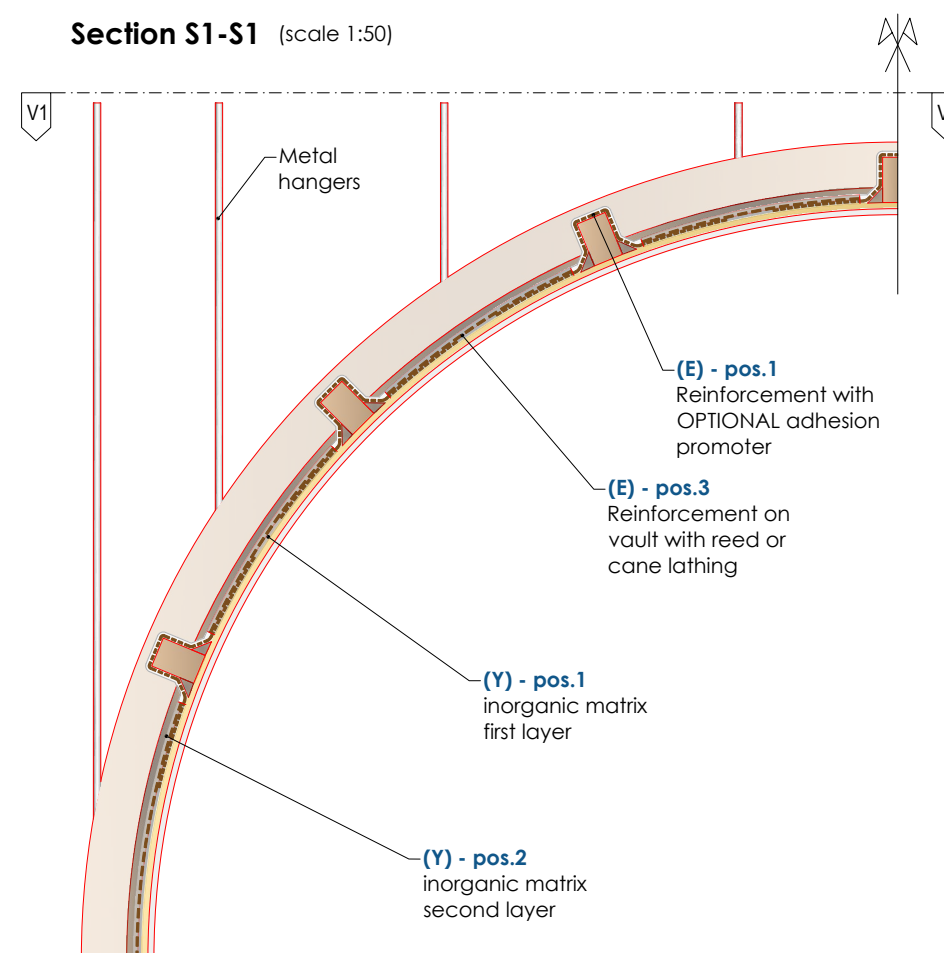

## WORK DESCRIPTION

**PHASE 0** - Substrate Preparation

All loose, weak, or detaching material must always be removed until sound substrate is reached.

Before applying the system, carefully clean the surface from dust, grease, efflorescence, and other contaminants.

If necessary, replace or reinforce any deteriorated wooden elements and apply anti-woodworm treatment to the entire wooden framework.

**PHASE 1** - Installation of Wooden Wedges

At the locations of the centering ribs and crossbeams, install suitable iroko wood wedges on both sides of the existing elements to support the integration of the mesh to be applied in subsequent Phases 3B and 3C..

**PHASE 2** - Application of the First Layer of Inorganic Matrix

On the prepared surface, apply a first layer of inorganic matrix, ensuring a uniform thickness of approximately 5 mm.

This layer may include the thickness required to level the substrate geometrically. To achieve a flat surface, application can be carried out using a spatula, trowel, or plastering pump.

**PHASE 3A** - Placement of Reinforcement on Wooden Centring Ribs and Crossbeams (pos.1 and pos.2)

Apply the (OPTIONAL) bonding promoter on the centering ribs, crossbeams, and wooden wedges.

Place the reinforcement over the centering ribs and crossbeams so that it overlaps by at least 300 mm onto the still-fresh inorganic matrix previously applied. The reinforcement must be carefully positioned and gently pressed with a flat spatula to ensure full embedding into the inorganic matrix.

Apply a second layer of (OPTIONAL) bonding promoter on the reinforcement installed over the wooden elements (centering ribs and crossbeams)..

**PHASE 3B** - Placement of Reinforcement on the Vault with Reed or Cane Lathing (pos.3)

While the inorganic matrix is still fresh, apply the reinforcement on the vault with reed or cane lathing (pos.3). The reinforcement must be carefully positioned and gently pressed with a flat spatula to ensure full embedding into the inorganic matrix.

At the junctions between reinforcement sheets, both longitudinally and transversely, an overlap of 300 mm must be ensured. Shorter overlaps are permissible only if supported by appropriate qualification tests according to the applicable LL. gg. stc 2022 and/or relevant EAD.

(\*) Before implementing an overlap shorter than 300 mm, verify whether qualification tests exist for the system being used.

**PHASE 4** - Application of the Second Layer of Inorganic Matrix

To ensure uniform and adequate coverage of the reinforcement, apply a second layer of inorganic matrix "fresh on fresh," taking care to achieve a total uniform thickness of at least 8 mm.

## MATERIAL IDENTIFICATION – C-MATRIX System

(Y) INORGANIC MATRIX

(E) REINFORCEMENT

(X) FB-.... (adhesion promoter)

Dimensions are expressed in mm unless otherwise specified  
For the materials table, refer to drawing FRCM 08

