

FRONT VIEW Reinforcement layout diagram (scale 1:25)

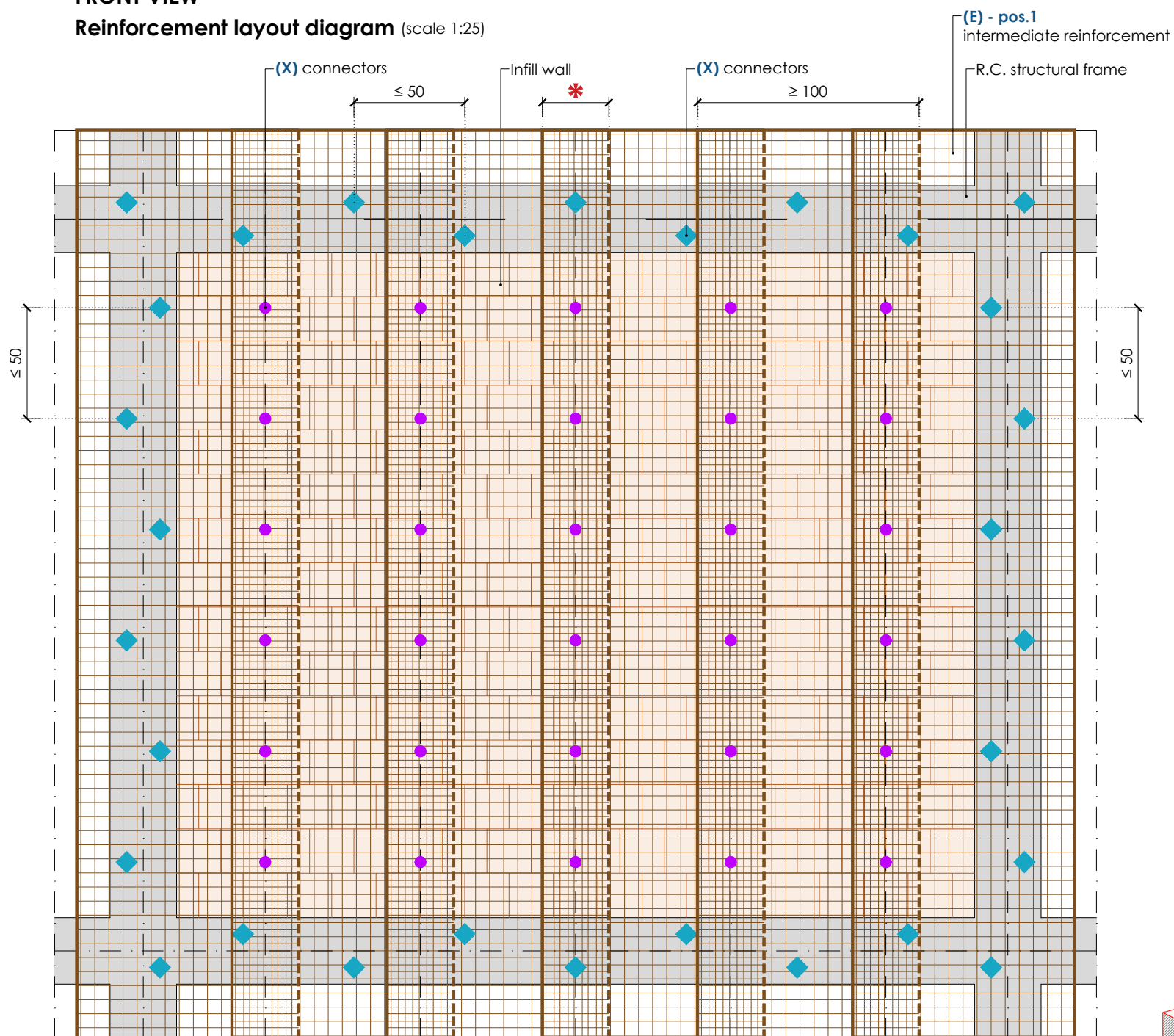

WORK DESCRIPTION

PHASE 0 - Substrate Preparation

All loose or detaching material must always be removed until sound substrate is reached.
For interventions on structural elements:
Before applying the system, carefully clean the surface of dust, grease, efflorescence, and other contaminants using pressure washing at an appropriate level.

FOR ALL SUBSEQUENT INSTALLATION PHASES, REFER TO DRAWING FRCM 01.a

Wall Detail of 1sqm of mesh

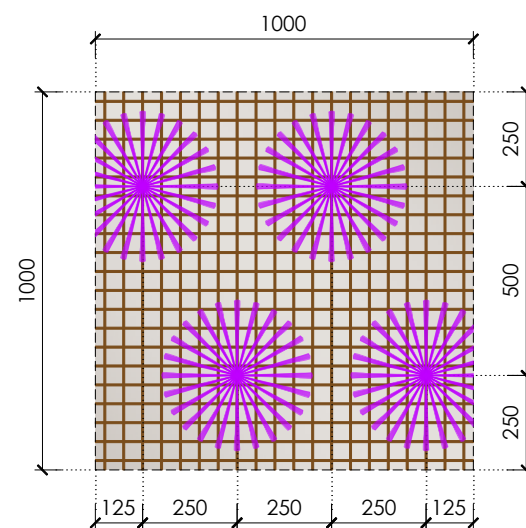

In the **MULTI-LAYER** infill wall, in addition to the fastening connectors to the structural frame and at the mesh overlaps, provide no. 4 connectors per sqm.

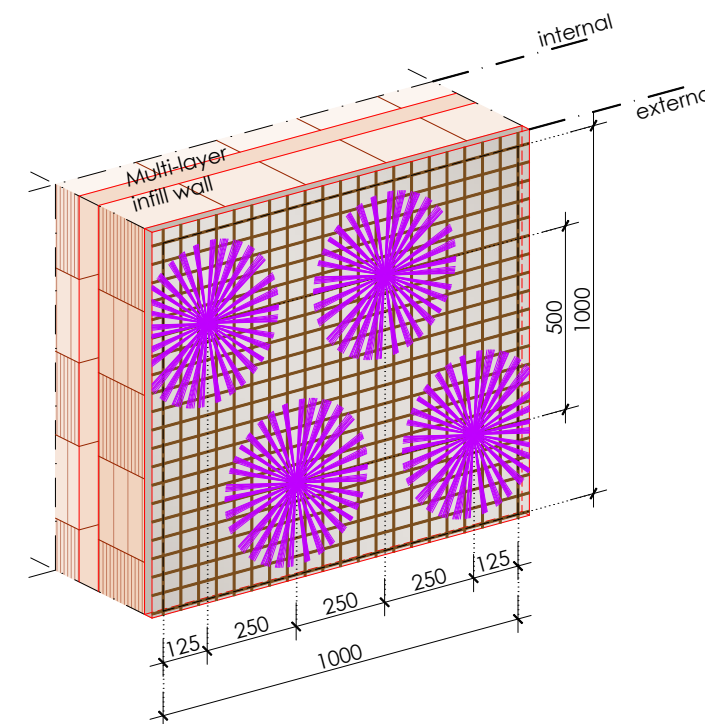

Detail Minimum reinforcement overlap

For the reinforcement mesh overlap length, refer to the description in PHASE 2 on drawing FRCM 01.a.

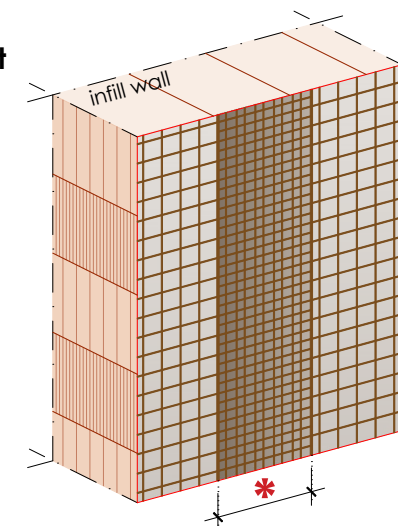

Installation sequence

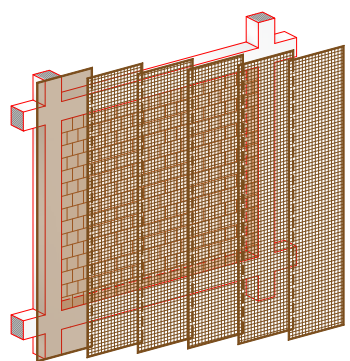

Reinforcement application COMPLETE

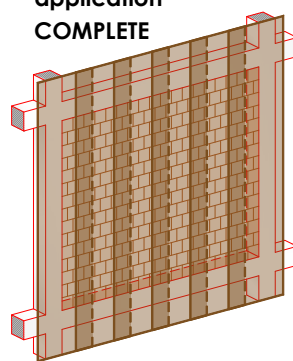

Note:

- Connectors on the infill wall
- ◆ Connectors on the structural frame

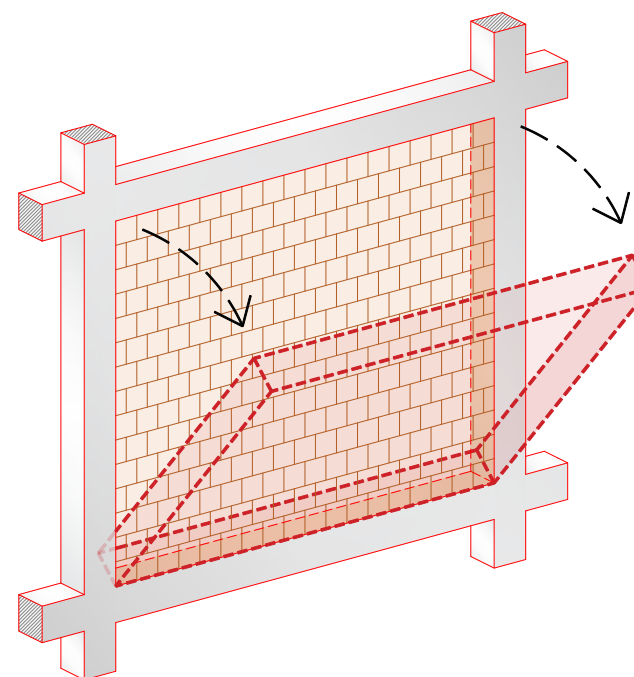

MATERIAL IDENTIFICATION - C-MATRIX system

- (Y) INORGANIC MATRIX
- (E) REINFORCEMENT
- (X) FB-TUP10-....(bowed connectors) or other type of connection system
- (P3) FB-....INTEGRA FIXA-.... (anchoring resin)

Dimensions are expressed in mm unless otherwise specified.
For the materials table, refer to drawing FRCM 08.

