

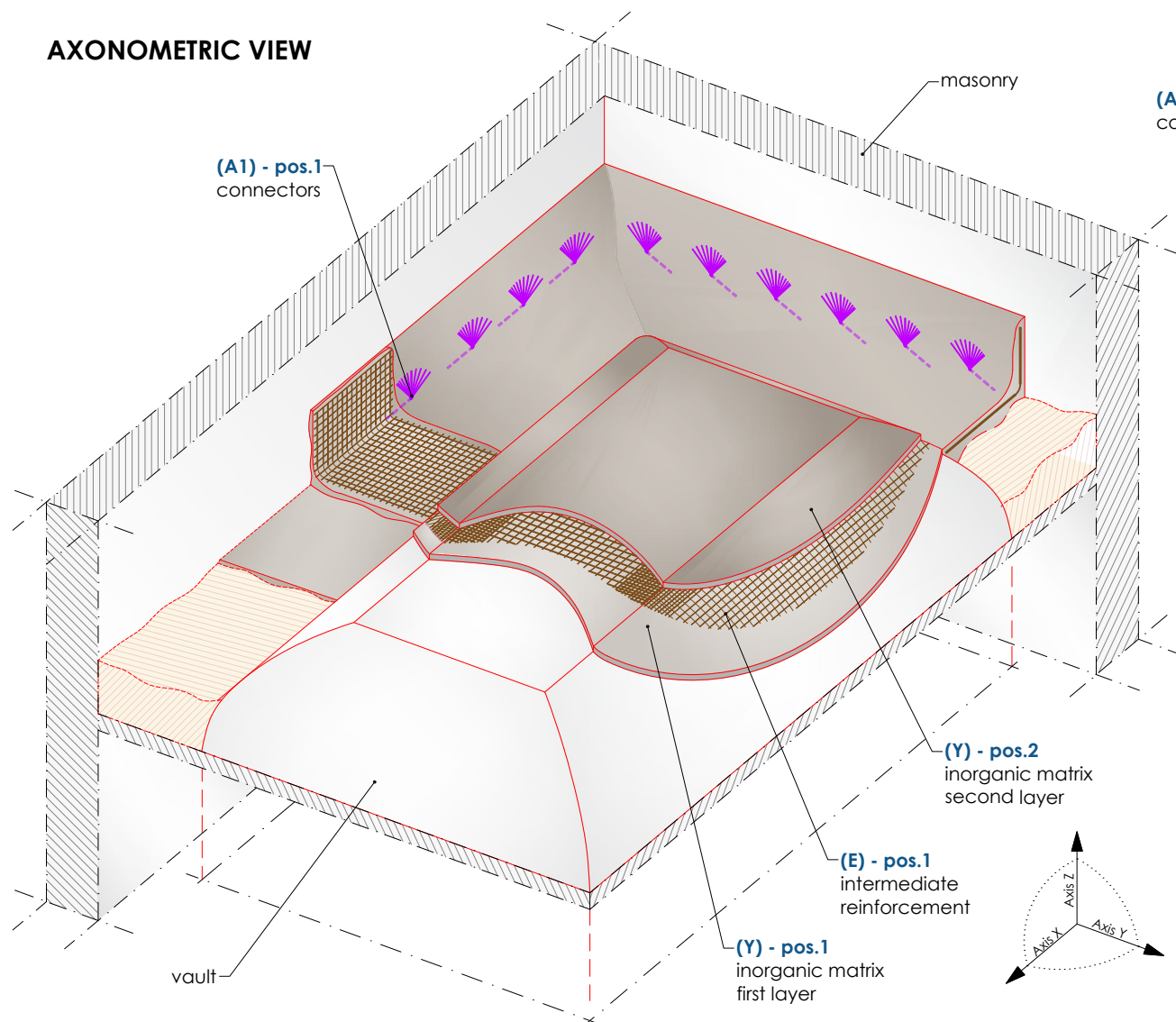

AXONOMETRIC VIEW

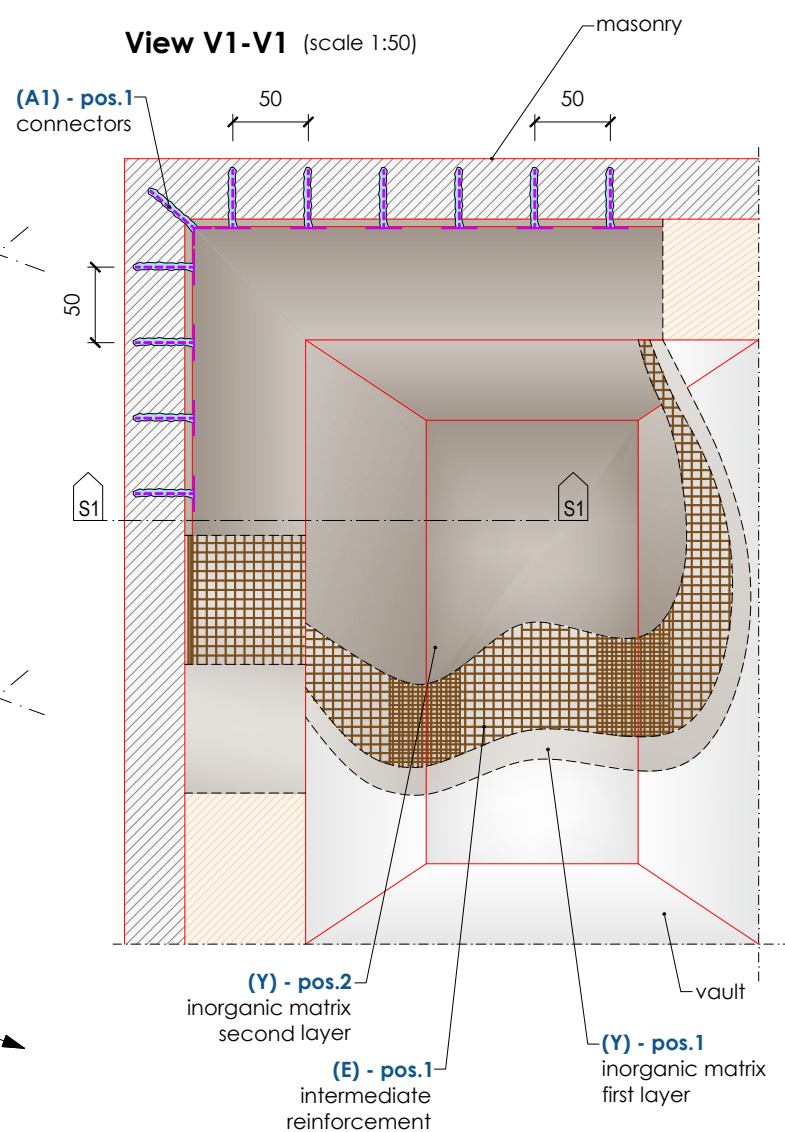

View V1-V1 (scale 1:50)



DETAIL SOLUTION "A" - Debowed connectors above the second layer of inorganic matrix

The layout, anchoring, and installation of the debowed connectors must be carried out only after the application of the second layer of inorganic matrix, embedded in the mortar or once the mortar has fully hardened.

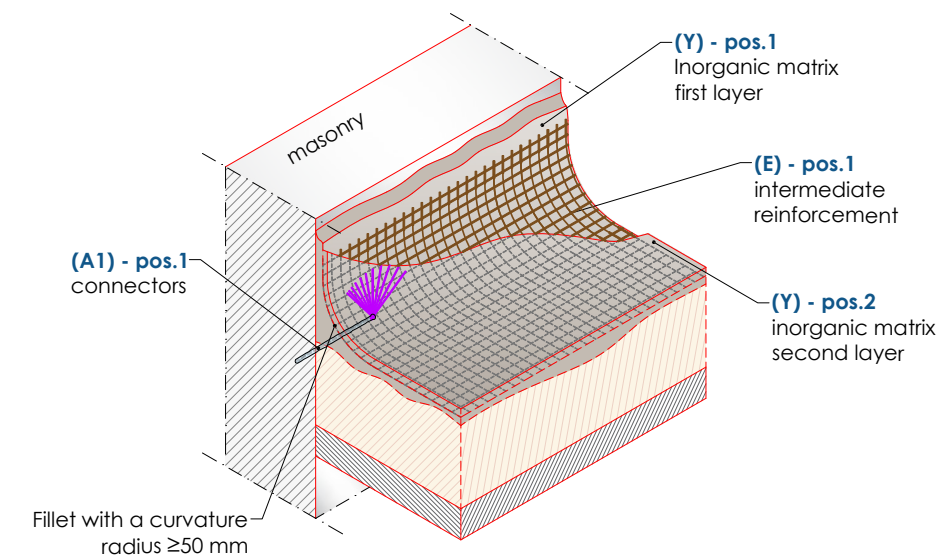

DETAIL SOLUTION "B" - Debowed connectors above the reinforcement

The layout and anchoring of the connectors must be carried out after Phase 0 of substrate preparation, while the installation of the debowed connectors is to be performed only after the reinforcement has been applied

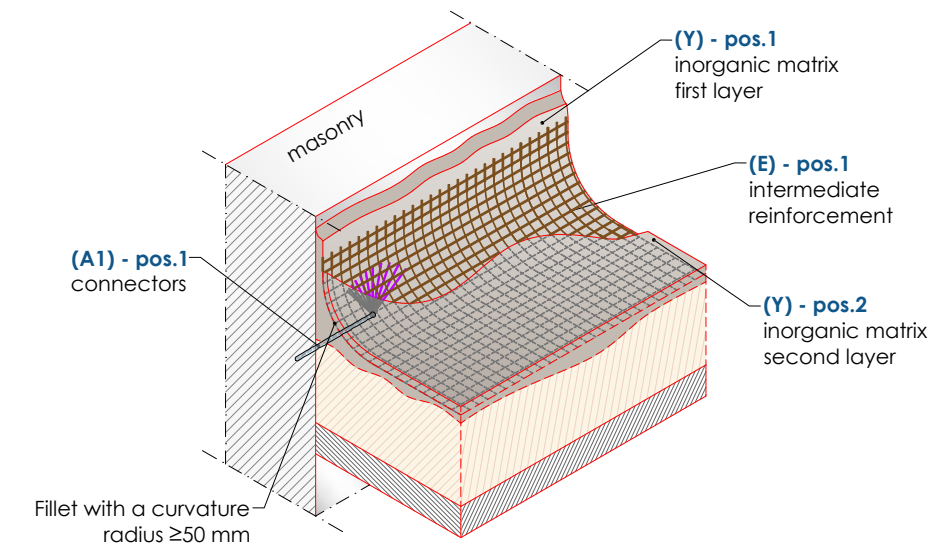

Stratigraphy detail

application of the second layer of mortar

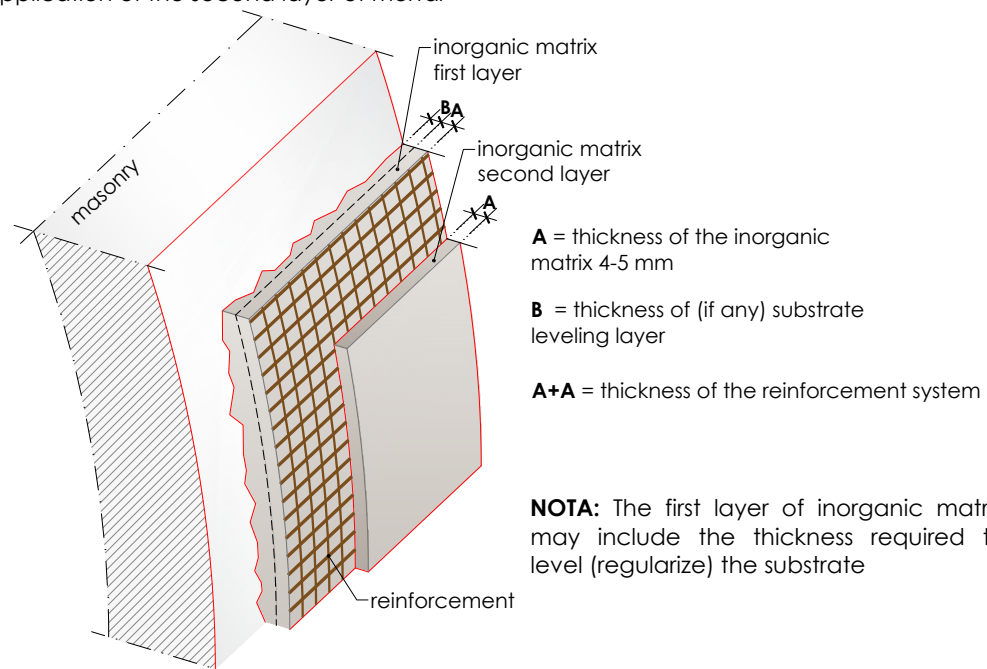

Section S1-S1 (scale 1:25)

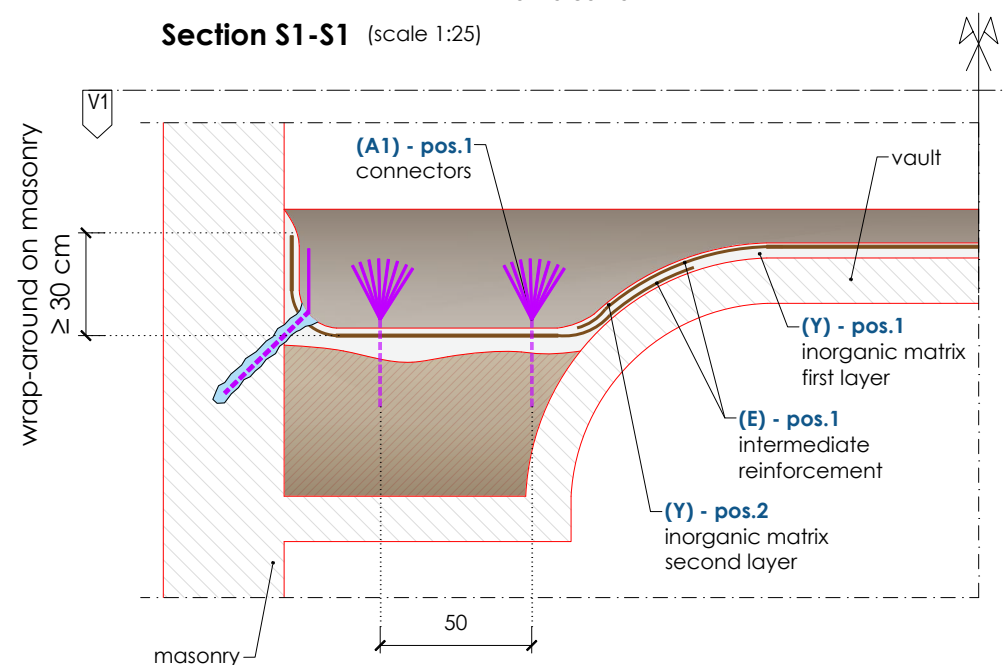

MATERIAL IDENTIFICATION - C-MATRIX SYSTEM

(Y) INORGANIC MATRIX

(E) REINFORCEMENT MESH

(A1) FB-TUP10-....(bowed connectors)

(P3) FB-....INTEGRA FIXA-.... (anchoring resin)

Dimensions are given in mm unless otherwise specified
For the materials table, refer to drawing FRCM 08